



The Churchill

A 4 bedroom, 2 1/2 bath gracious home with a two-car garage, and full basement

Elevation "A"



Elevation "B"



Kitchen

11'5" x 11'1"

Nook

8'8" x 8'0"

Dining Room

11'5" x 10'0"

Family Room

18'0" x 12'1"

2 Car Garage

19'9" x 19'5"



Main Bedroom

12'0" x 16'9"

Bedroom #2

11'9" x 12'0"

Bedroom #3

12'0" x 10'2"

Bedroom #4

10'0" x 12'0"

Additional Spaces

- Master Bathroom
- 2nd Bathroom
- 2 Walk-in Closets
- Laundry
- Powder Room

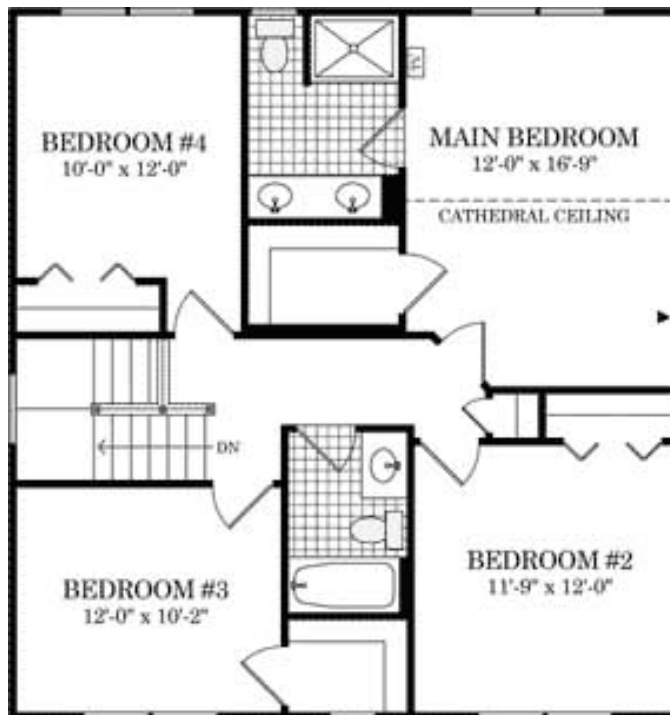

All information is deemed reliable but is not guaranteed. Properties that are shown are subject to change, prior sale or withdrawal. Neither listing brokers nor information providers shall be responsible for any typographical errors, misinformation, or misprints, and shall be held totally harmless.